

Aurora II Monitoring Station

(5 wells)

PCS Mine

Maintenance Area

NC Hwy 306

SR 1942

railroad

South Creek

PCS Phosphate/
Nutrien

forest

Brantley Swamp Rd

Whitehurst Creek

Aurora & NC Hwy 33 ~1.5 miles

PCS Mine

500 ft

Site Map

North Carolina

Monitoring Well Network

Aurora II Site, Q 17D

North of Aurora, Beaufort County, NC

Note: This map is for informational purposes only. It does not authorize any party to enter onto any lands depicted herein.



Latitude: 35.326100
Longitude: -76.803341

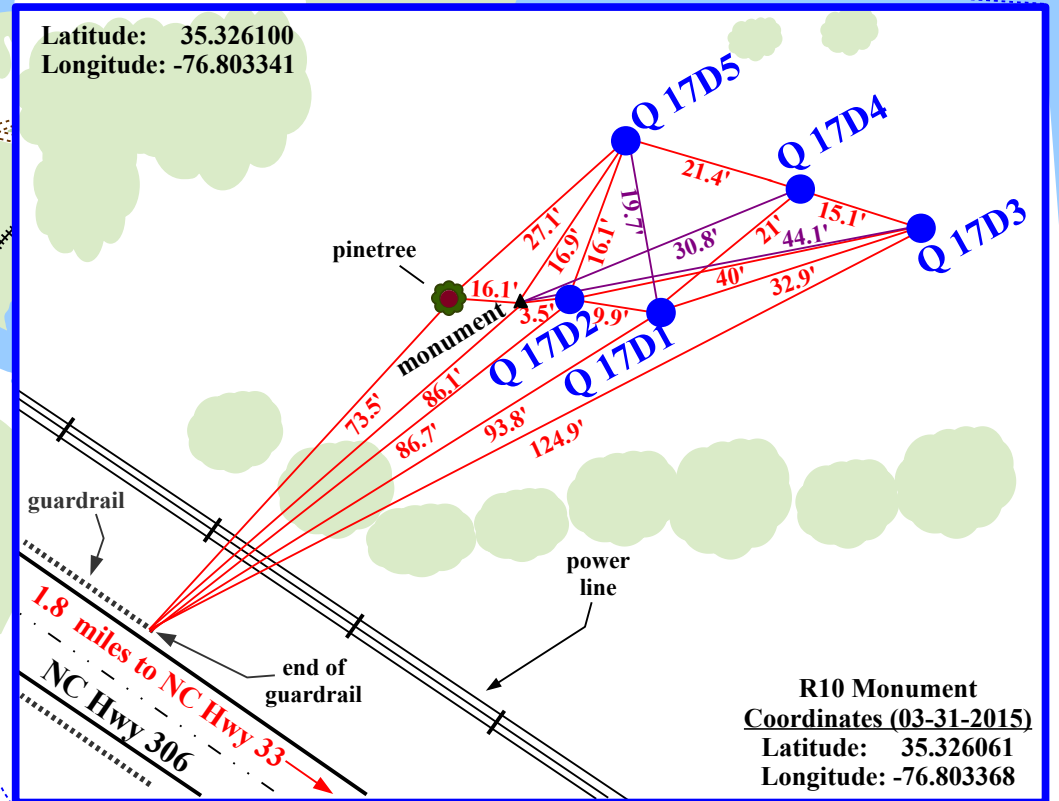

R10 Monument
Coordinates (03-31-2015)
Latitude: 35.326061
Longitude: -76.803368